

## Fitting Instructions for Oscillating Seed Tray Vibration Kit

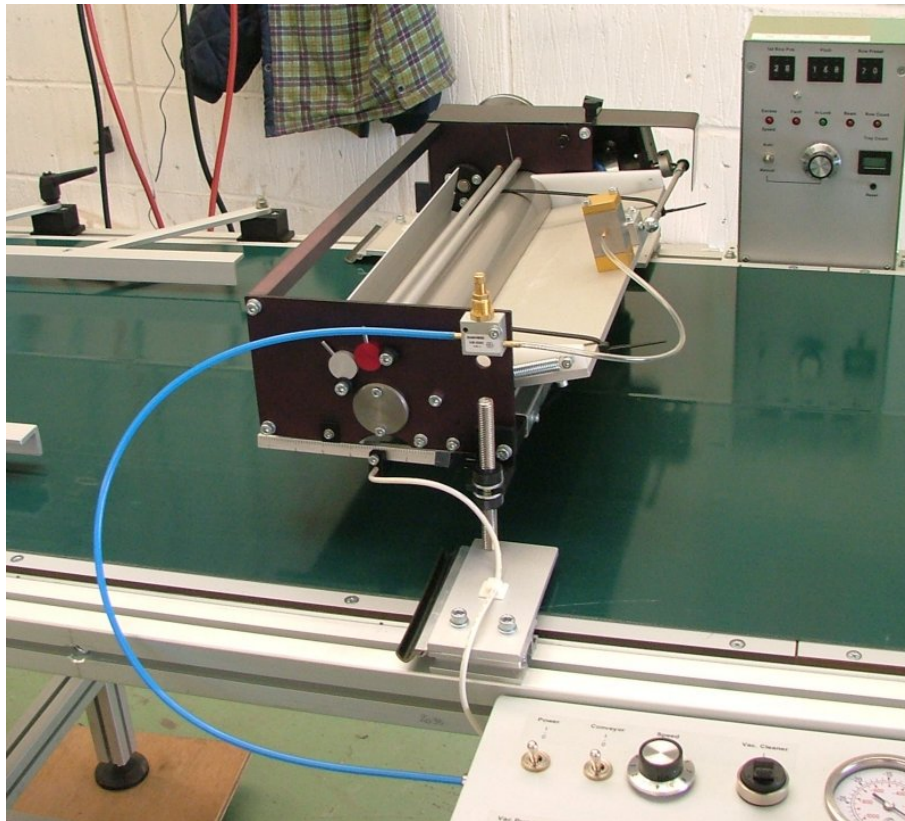

It is necessary to drill two holes in the tray base to attach the vibrator. The position of these holes is important, and your distributor can provide a jig to ensure accurate positioning. Please ensure the jig is returned after fitting.

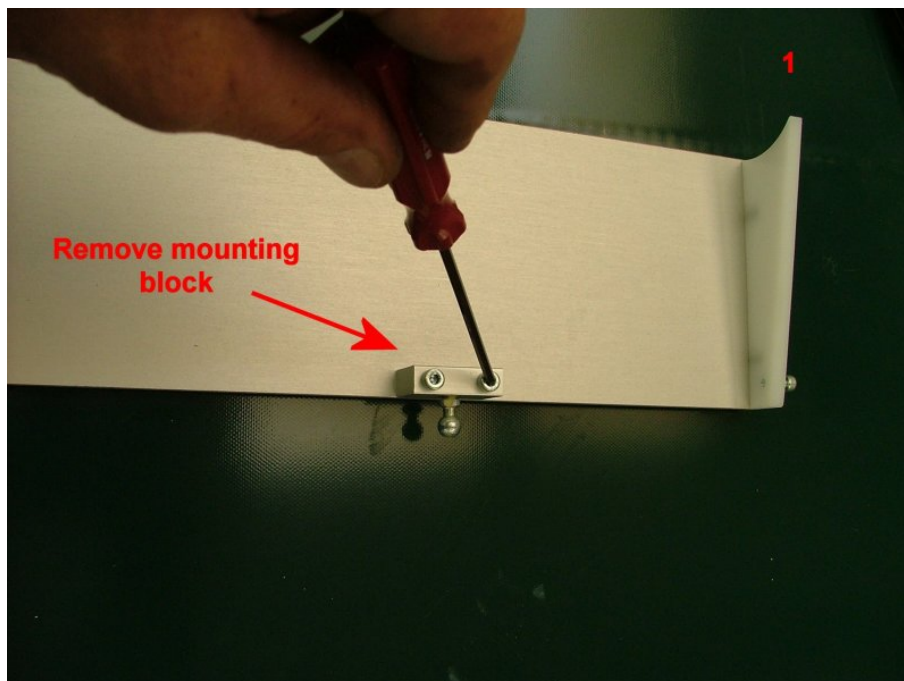

1) Remove the tray, and the mounting block.

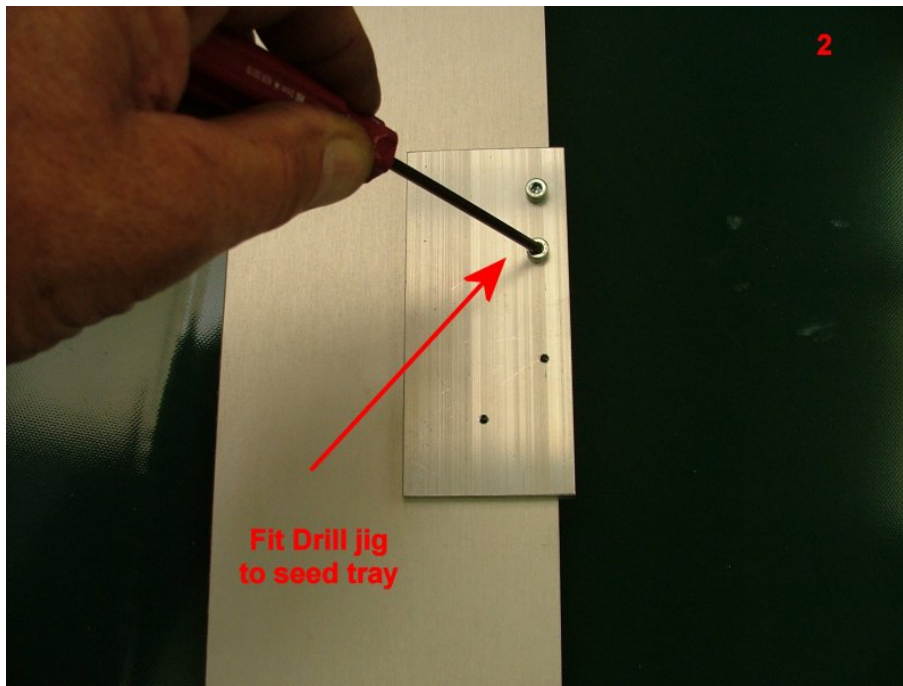

2) Fit the jig to the top of the tray

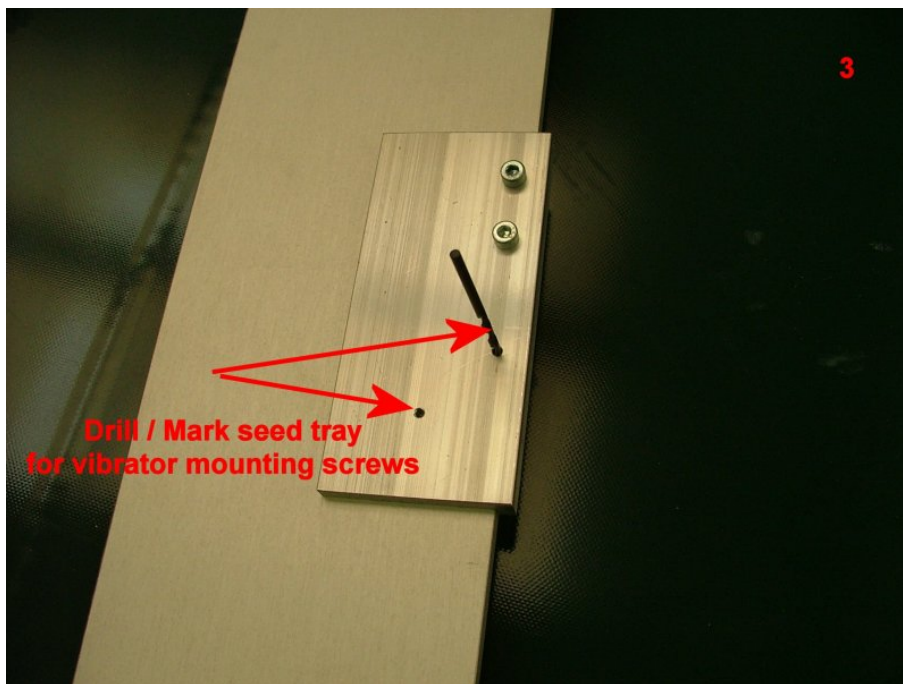

3) Using the 3.5mm drill provided, drill through the template and tray to provide a pilot hole

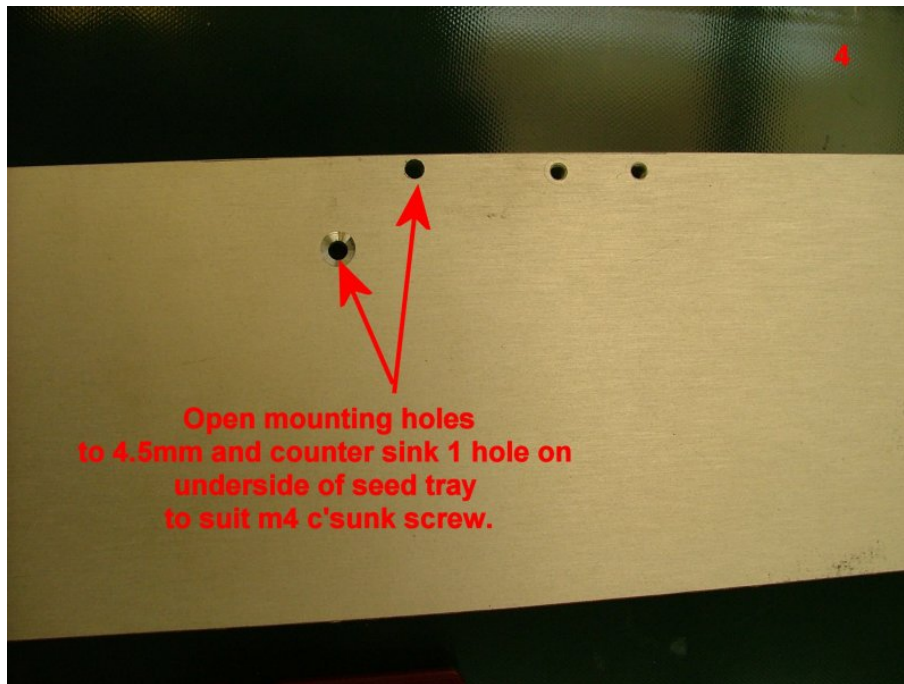

- 4) Turn the tray over, and drill through the pilot holes to open them out with a 4.5mm drill. Countersink the lower hole so that the head of the countersunk screw will be flush with the surface.

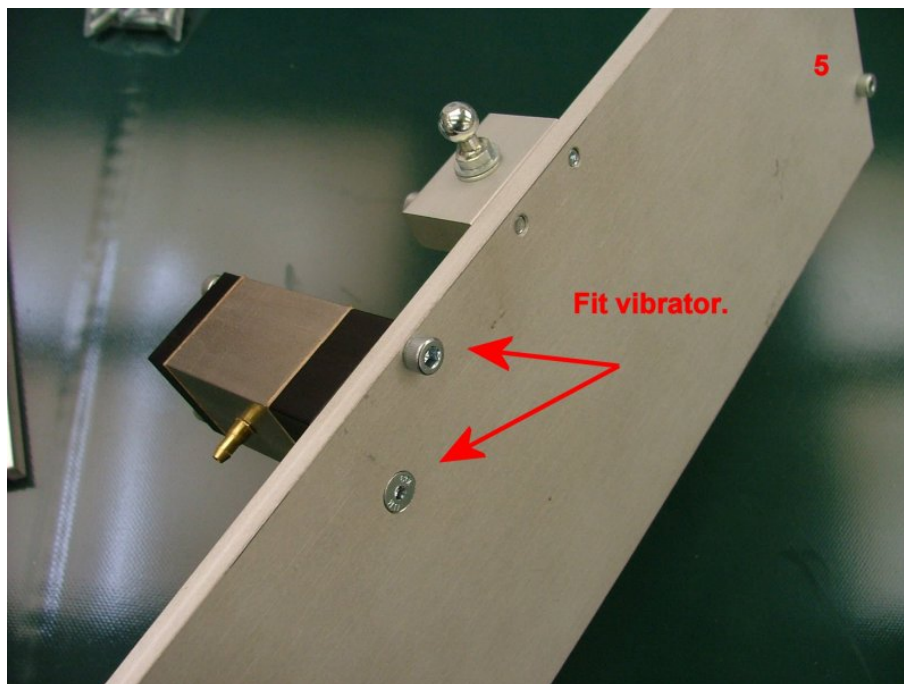

- 5) Attach the vibrator as shown, and refit the tray to the seeder
- 6) Fit the flow regulator to the end plate of the seeder head as shown on page 1, and connect the tube to the vacuum cleaner port on the control box.